

Dual Panel Solar Fountain

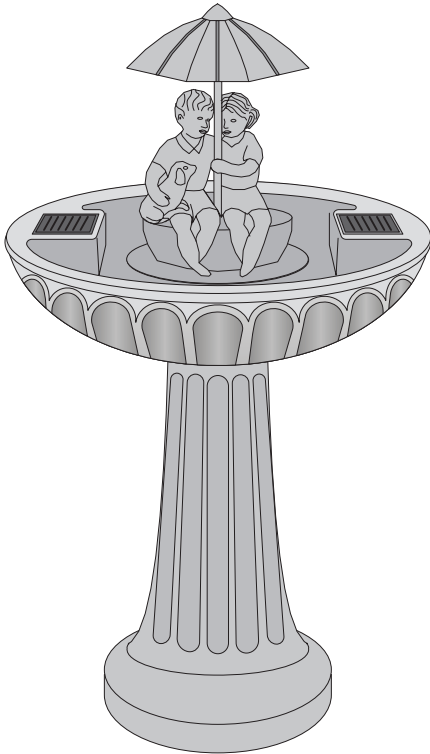

* Styles may vary but assembly will be consistent with this manual



Umbrella Style

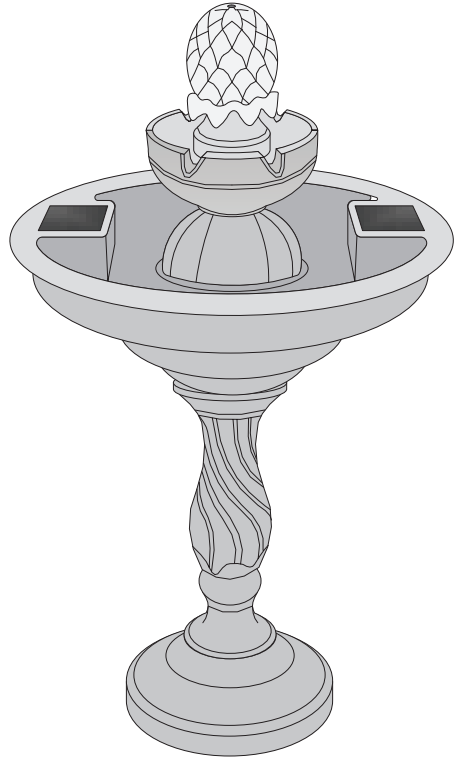

Sculpture Style

Warning! Important! Read Me!



In strong sunlight or windy conditions, the water may spray outside of the birdbath. We recommend the water be regularly topped off and changed to ensure it remains clean and free from debris. Shallow birdbaths require more frequent filling due to evaporation.



Frost / freezing temperatures cause damage. Empty water and store whole product indoors (garage, shed, basement) during winter if you live in an area where temps fall below 40°F. Leaving it outside and covering it does not count as winter storage. Any parts damaged by freezing temps are not covered under warranty.

Umbrella Style Fountain Assembly

1. Attach the main bowl to the pedestal. Align the marks and turn to lock in place.
2. Place the solar panels in the recesses provided running the cables through the holes in the side.
3. Connect the solar panels to the pump taking care to ensure the connectors are water tight. Push the plugs together until they touch the rubber o-ring, slide the threaded cap over the plug and turn the cap until tight.

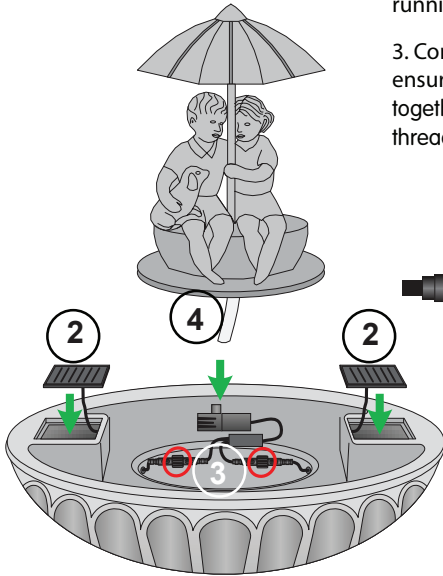

! Important

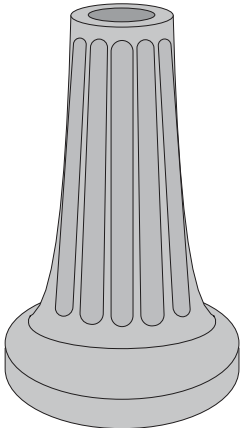
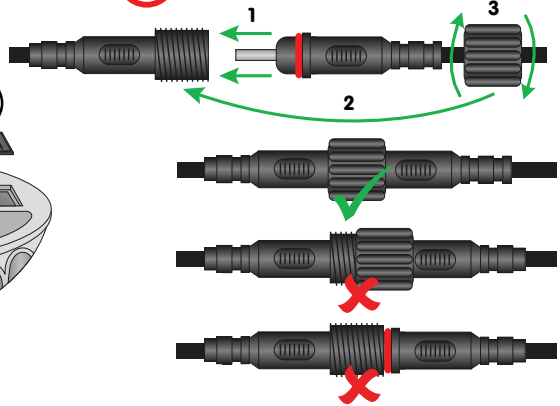

4. Connect the hose from the umbrella statue to the pump and lower it into place. Ensure the pump and cables are neatly stored in the recess provided.
5. Fill the main bowl with water.

Note: Water must be regularly topped off. We recommend regularly changing the water to ensure it remains clean and free from debris.

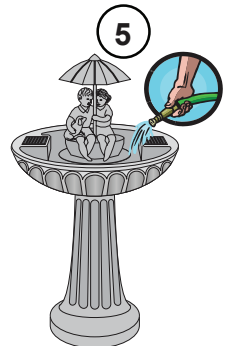

Sculpture Style Fountain Assembly

1. Attach the main bowl to the pedestal. Align the marks and turn to lock in place.
2. Place the solar panels in the recesses provided running the cables through the holes in the side.
3. Connect the solar panels to the pump taking care to ensure the connectors are water tight. Push the plugs together until they touch the rubber o-ring, slide the threaded cap over the plug and turn the cap until tight.

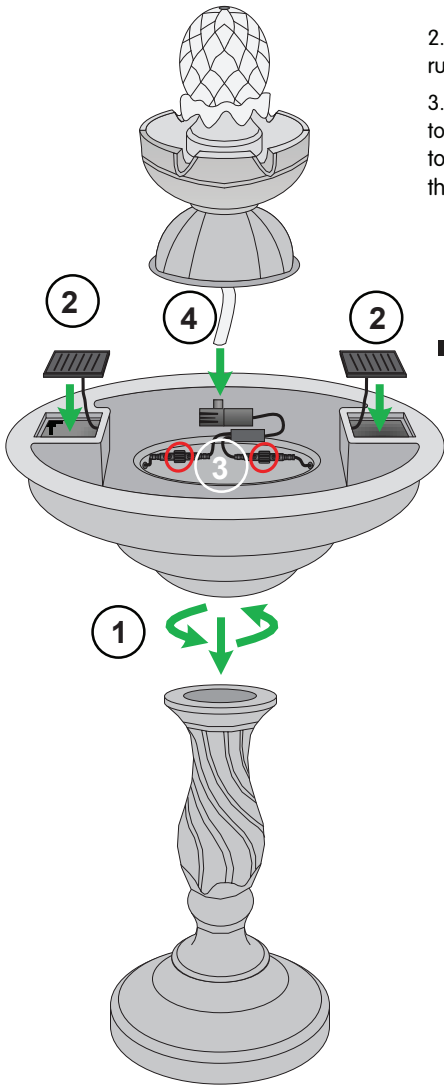

! Important

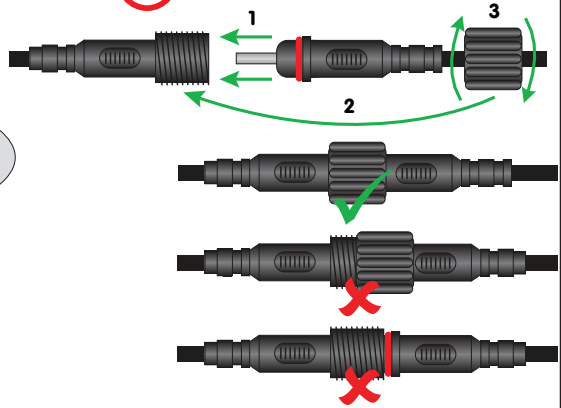

4. Connect the hose from the pineapple to the pump and lower it into place. Ensure the pump and cables are neatly stored in the recess provided.
5. Fill the main bowl with water.

Note: Water must be regularly topped off. We recommend regularly changing the water to ensure it remains clean and free from debris.



Position

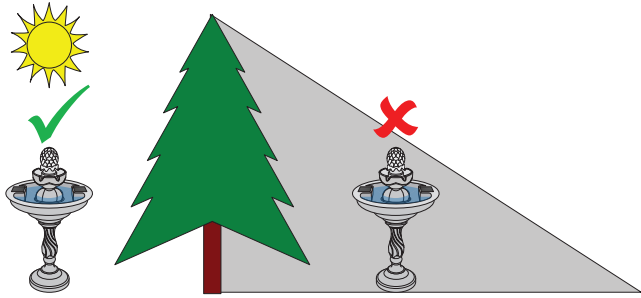

Position your fountain so that receives direct sunlight. The fountain will NOT work if the solar panels are in a shaded area

✓
Direct Sun

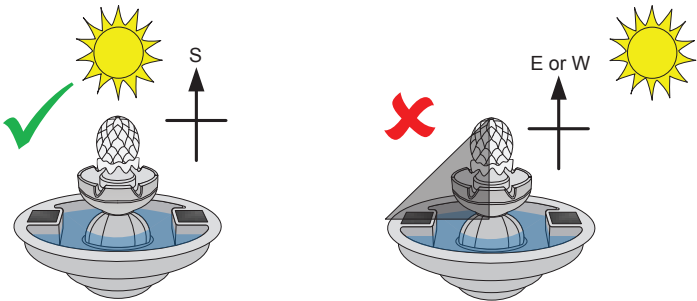
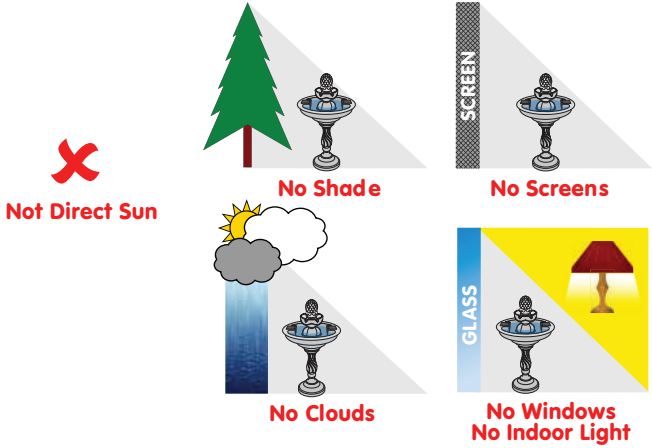
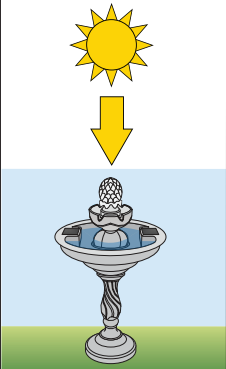

In order to minimize the chances of the final shading one of the solar panels ensure that the fountain is south facing.

If shading does occur, simply rotate the fountain until the panels are in sunlight.

Performance

This product is designed primarily to operate in summer months but will also work in spring and autumn provided there is good sunshine. Performance is directly related to the amount and strength of sunlight received.

Sculpture

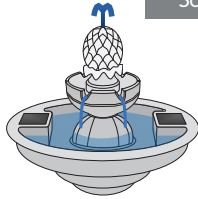

In bright direct sunlight your pump will work well with a consistent fountain height and flow rate.

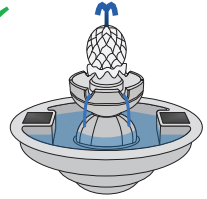

In slightly cloudy conditions your pump will work however fountain height and flow will vary as clouds pass in front of the sun.

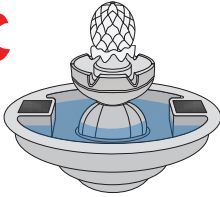

In overcast conditions the solar panel does not generate enough power to run the pump and it will NOT work.

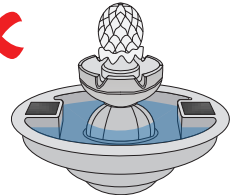

At night the solar panel does not generate power and your pump will NOT work.

Umbrella



In bright direct sunlight your pump will work well with a consistent fountain height and flow rate.



In slightly cloudy conditions your pump will work however fountain height and flow will vary as clouds pass in front of the sun.



In overcast conditions the solar panel does not generate enough power to run the pump and it will NOT work.



At night the solar panel does not generate power and your pump will NOT work.

Plug Connections

! Important

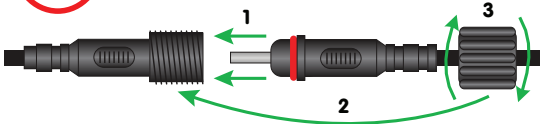

Ensure connections from both solar panels to pump are water tight.

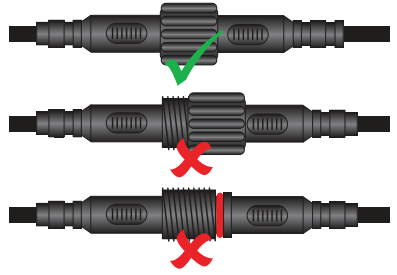

Pump Cleaning

Clean the metal prong on the back of the pump which is the water sensor.

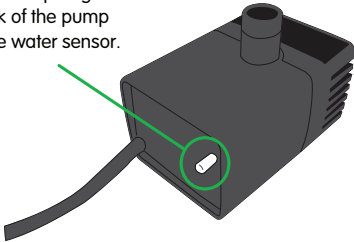

Filter cover can simply be pulled apart as shown.

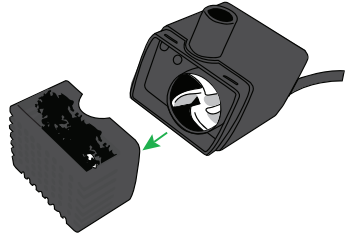

Remove filter material and rinse in water.

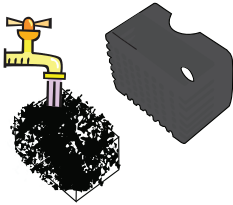

Pull out the white impeller fan. Rinse parts thoroughly in water.

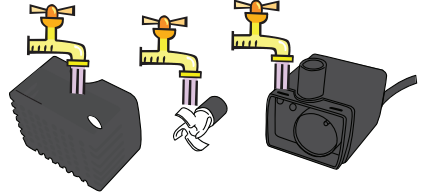

Maintenance

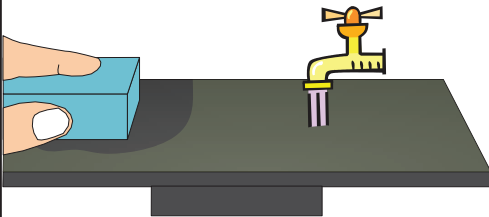

To maintain optimum performance regularly clean the solar panel using water or glass cleaner with a sponge or cloth. You can use vinegar to remove hard water limescale.

Auto On/Off Water Sensor

This pump is equipped with a built in water sensor that uses a metal prong on the back of it. The pump can run when the prong is wet. If the water level gets too low due to splashing or evaporation and the pump is no longer under water, once the prong dries off it will automatically stop running to prevent the motor from running dry. When it's back under water and in direct sun it will automatically start running again.

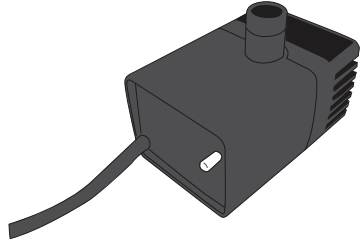

Troubleshooting

IF IT'S NEW AND NOT WORKING...

Ensure the plug connections from the pump to the splitter and to each panel are connected tightly (page 6). Ensure the spout from the pump is inserted into the hose from the statue (page 2/3).

Check the water level to ensure the pump is fully submerged.

Position the fountain in a spot that receives direct sun without any shade (page 4).

If it's too cloudy you may need to wait until the weather improves (page 5).

If it's too early in the morning you may need to wait until the sun is higher.

If it's too late in the evening you may need to wait until the following day.

IF IT'S WORKING BUT WEAK...

Disconnect the plugs, make sure it's clean. Wipe it off and reconnect tightly (page 6).

Clean the solar panels if algae or hard water limescale make them look cloudy (page 6).

Remove the filter mesh and clean it to reduce the water flow restriction (page 6).

Remove the white impeller fan from the pump to ensure it's no build up or debris (page 6).

Flush out the tube that goes up through the statue to ensure there are no blockages.

You may need to wait until the weather improves and you have more direct sun.

If it's too cloudy you may need to wait until the weather improves (page 5).

If it's too early in the morning you may need to wait until the sun is higher.

If it's too late in the evening you may need to wait until the following day.

IF IT STOPS WORKING...

Try the steps as above and if it's still not working try manually starting the pump (as shown below)

Manual Start

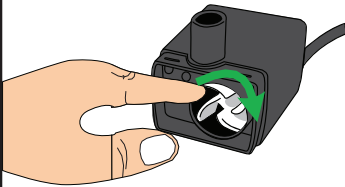

If the pump is not working try to manually start it. Remove the front filter cover, have both of the solar panels in direct sun, have the metal prong on the back of the pump in water, and spin the white impeller fan clockwise for up to 1 minute

Warning! Important! Read Me!

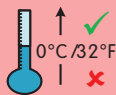

Frost / freezing temperatures cause damage. Empty water and store whole product indoors (garage, shed, basement) during winter if you live in an area where temps fall below 40°F. Leaving it outside and covering it does not count as winter storage. Any parts damaged by freezing temps are not covered under warranty.

Warranty

Smart Living Home and Garden warranties your solar panel, pump, and birdbath for one (1) year from the original date of purchase from authorized distributors and retailers. The warranty covers parts that are properly installed and regularly maintained. If the product fails due to a defect in material or workmanship, Smart Living will replace the defective parts free of charge. Your fountain will last for many years with proper care.

Please unpack and inspect the entire product upon receipt. Report any broken or missing pieces within five (5) business days of receipt to our customer service department and we will provide replacement parts free of charge. Please do not discard any damaged parts until instructed to do so by our customer service department.

Thank You!

Thank you for purchasing a Smart Living Home & Garden product.

Welcome to the family! You can visit our website to register your product, leave a review, or check out our FAQ page, or order replacement parts.

Our products are thoughtfully designed by a dedicated team based in the USA. While we aim high, we acknowledge that defects can occur as part of the manufacturing process. If our QC team missing something and you experience an issue we apologize for the inconvenience. Please contact us using the info below.

Contact Us



Smart Solar is a Smart Living Home & Garden brand

Telephone: + 1 813 343 5775 **Email:** customerservice@smartlivinghg.com

Web: www.smartlivinghg.com

US Patent 7484671 & EU Patent 1648620

1 Year Limited Manufacturer's Warranty

